

Technical data sheet

SOLL 2K CLEARCOAT SPRAY is a fast drying 2K Clearcoat for clear-over-base coating with an excellent flow. Due to the chemical cross-linking with the integrated hardener, this product is highly resistant to all weather influences as well as to chemical agents and mechanical stress. In addition, SOLL 2K CLEARCOAT SPRAY is fuel-resistant!

Processing instructions

Substrate:

Water- and solvent-based basecoats, cured and sanded old paintworks.

Pre-treatment / Cleansing:

see „substrate preparation“.

Characteristics:

High UV protection, yellowing-resistant, lightfast
Outstanding weather and scratch resistance
Excellent flow and spray result
Safe and clean transfer of the hardener
Very resistant to mechanical stress and chemical agents
Fuel-resistant

**Colour /
Gloss level:**

Colourless
high-gloss

Preparation:



Before use, shake can vigorously for 1 - 2 min!

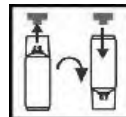

Right before spraying, take the red button from the cap, turn the spray can 180° and attach the button to the pin on the bottom of the aerosol.

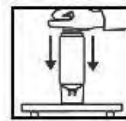

Place the spray can with the cap upside down on a solid surface. Press the red button down with the heel of your hand until a stop is reached.

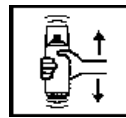

After the activation, shake can again vigorously.

Application:



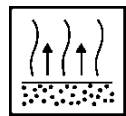

Spray to test - spray distance approx. 20 - 30 cm
2 - 3 coats, dry film thickness: 40 - 50 µm

Flash-off:



3 - 5 min between coats
10 - 15 min before oven drying

Technical data sheet

After use:		After use, turn can upside down and spray until the valve is clean, this prevents the valve from clogging up.								
Drying time at 20 °C		<table border="0"> <tr> <td>Dust dry after approx.</td> <td>5 min.</td> </tr> <tr> <td>Set to touch after approx.</td> <td>10 min.</td> </tr> <tr> <td>Ready for assembly after approx.</td> <td>30 min.</td> </tr> <tr> <td>Polishable after approx.</td> <td>8 - 9 h (if necessary, only applies to SOLL 2K CLEARCOAT SPRAY).</td> </tr> </table>	Dust dry after approx.	5 min.	Set to touch after approx.	10 min.	Ready for assembly after approx.	30 min.	Polishable after approx.	8 - 9 h (if necessary, only applies to SOLL 2K CLEARCOAT SPRAY).
Dust dry after approx.	5 min.									
Set to touch after approx.	10 min.									
Ready for assembly after approx.	30 min.									
Polishable after approx.	8 - 9 h (if necessary, only applies to SOLL 2K CLEARCOAT SPRAY).									
Processing conditions:	From +10°C and up to 80% relative air humidity. Ensure adequate air ventilation.									
Storage:	In tightly closed containers, kept in a cool, dry place, 2 years shelf life.									
VOC content:	EU limiting value for the product (cat. B/e): 840 g/l This product contains a max. 840 g/l									
Safety instructions:	See the corresponding Material Safety Data Sheet.									
Processing instructions	Pot life approx. 5 - 6 h at 20 °C									
Substrate preparation:	<p>Remove old coatings or primers that have not cured or are not sound. Do not use on thermoplastic substrates.</p> <p>Intact, sound old paintworks, factory paintings:</p> <ol style="list-style-type: none"> 1. Pre-clean with silicone remover. 2. Then sand with P 400 - 500. 3. Afterwards, degrease with silicone remover. 									

This data sheet is for information purpose only! The information given is in accordance to our knowledge up to the latest standards and is based on years of experience in the manufacture of our products. The information is nonbinding and without guarantee.